

SPECIFICATIONS:

- Voltage Rating: 130V AC/DC
- Current Rating: 1A AC/DC
- Withstanding Voltage: 800V AC/Minute
- Temperature Range: -25°C~+85°C
- Insulation Resistance: 1000MΩ Min.
- Contact Resistance: 20mΩ Max.
- Applicable Wire Range: AWG#26~30.

Assembly Layout:

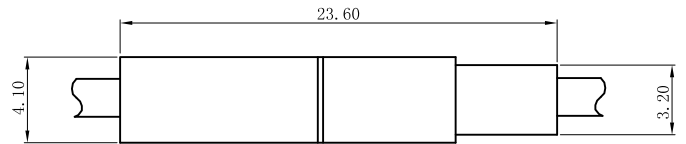

C2510HF-NP-NOXX

2.50mm Pitch Single Row Housing

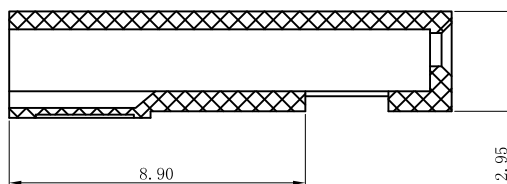
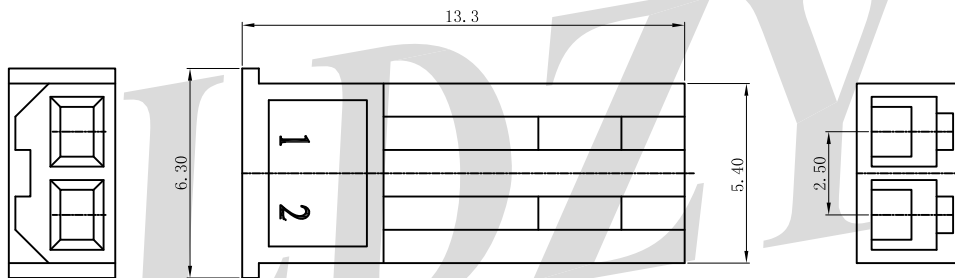

Reference Informations:

- *Material:
Housing: PA66 UL94V-0/White or Red
- *Suitable LDZY C2510 series Terminal
- *Mates with LDZY C2510 Male Housing

C2510HM-NP-NOXX

2.50mm Pitch Single Row Housing

Reference Informations:

*Material:

Housing: PA66 UL94V-0/White or Red

*Suitable LDZY C2510 series Terminal

*Mates with LDZY C2510 Female Housing

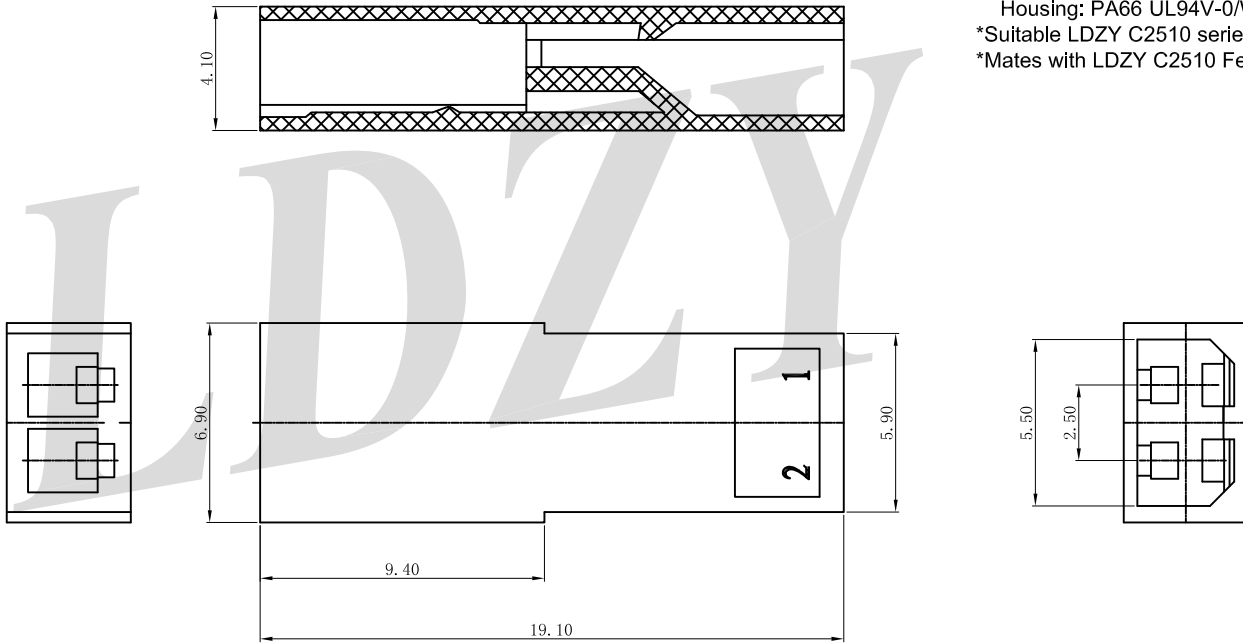

C2510TF-PXX

2.50mm Pitch Terminal

Reference Informations:

*Material: Phosphor Bronze/Tin-plated or Gold Flash

*Mates with LDZY C2510 series Housing

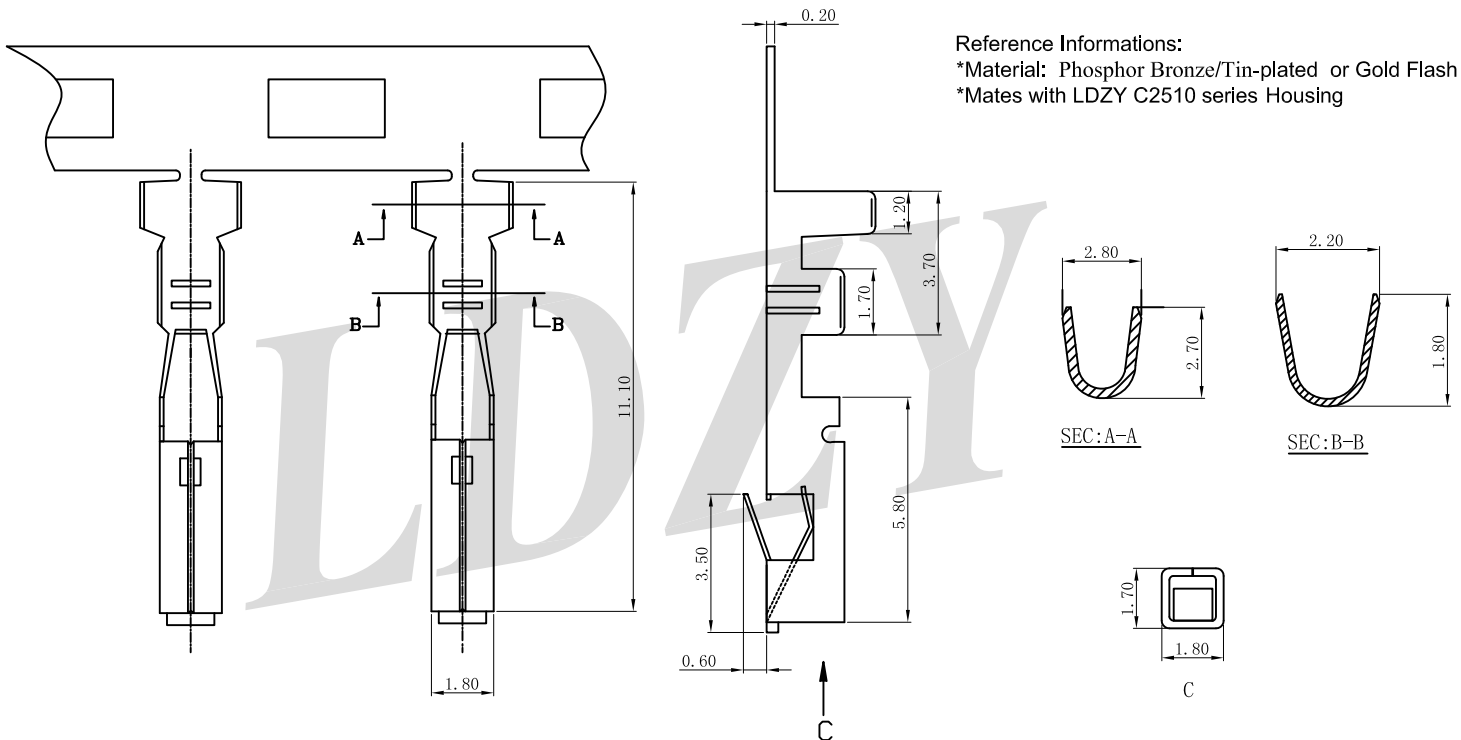

Ordering Information & Specifications

Part No	Wire Range	Insulation O.D.	Material	Finish	Qty/reel
C2509TF-PT1	AWG#26-#32	1.10mm(max)	Phosphor Bronze	Tin-plated	8,000pcs
C2509TF-PG1	AWG#26-#32	1.10mm(max)	Phosphor Bronze	Gold Flash	8,000pcs

C2510TM-PXX

2.50mm Pitch Terminal

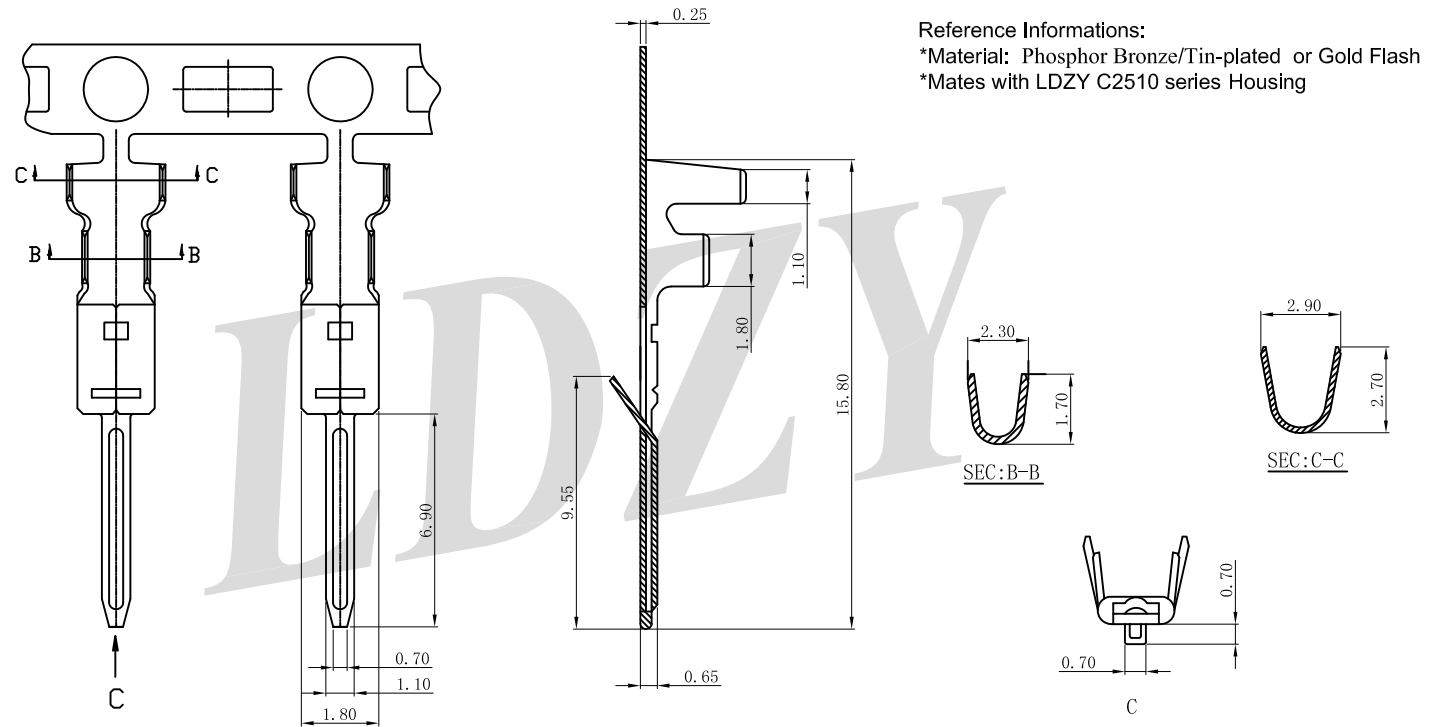

Part No	Wire Range	Insulation O.D.	Material	Finish	Qty/reel
C2510TM-PT1	AWG#26-#32	1.10mm(max)	Phosphor Bronze	Tin-plated	10,000pcs
C2510TM-PG1	AWG#26-#32	1.10mm(max)	Phosphor Bronze	Gold Flash	10,000pcs